

North ↑

7

N. Long

1/2 CORNER OF Sec 21, Twp 19 N., R. 30 W.

Deed Record 28, page 630

The Academy Addition to Rogers, Arkansas

L 1400/100

H 65 I # 14

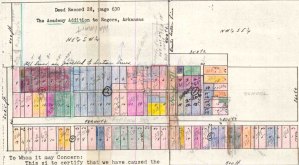

To Whom it may Concern:

This is to certify that we have caused the following described property situate in the County of Benton, State of Arkansas, to-wit: A part of the NW 1/4 of SE 1/4 & part of the SW 1/4 of SE 1/4 of Section 12, Township 19 Range 30 as described in the above plat to be surveyed into blocks and lots as shown in the above plat & said blocks are numbered as therein indicated & all distances are marked in feet & decimals thereof. And we hereby dedicate to public use all the Streets and alleys therein indicated.

Witness our hands & seals this 15th day of February, 1869.

J. W. Scraggs (SEAL)
James Egan (SEAL)

Filed for Record, February 15th, 1869 at 12 M.

Sheet